



**BRESSER**<sup>®</sup>  
PHOTOSTUDIO EQUIPMENT



Studioblitz · Studio flash  
Flash de studio · Flash de estudio

**CM-300/400/500/600/800/1000/1200**

Art. No. F000001 · F000016 · F000017

**EN** Instruction Manual

# Contents

<b>1 Features.....</b>	<b>3</b>
<b>2 About this Instruction Manual.....</b>	<b>3</b>
<b>3 Intended Use .....</b>	<b>3</b>
<b>4 Parts overview and scope of delivery .....</b>	<b>4</b>
<b>5 Screen display .....</b>	<b>5</b>
<b>6 Setting up power supply.....</b>	<b>5</b>
<b>7 Start function menu.....</b>	<b>5</b>
<b>8 Select modeling light mode.....</b>	<b>5</b>
<b>9 Setting the modeling light brightness .....</b>	<b>6</b>
<b>10 Setting the flash power .....</b>	<b>6</b>
<b>11 Flash test triggering .....</b>	<b>6</b>
<b>12 Flash synchronization and red-eye reduction .....</b>	<b>6</b>
<b>13 Switching on/off the acoustic signal .....</b>	<b>6</b>
<b>14 Cooling fan and temperature display .....</b>	<b>6</b>
<b>15 Overheating protection .....</b>	<b>6</b>
<b>16 Child safety lock.....</b>	<b>7</b>
<b>17 Fuse replacement.....</b>	<b>7</b>
<b>18 Technical data.....</b>	<b>7</b>
<b>19 EC Declaration of Conformity .....</b>	<b>8</b>
<b>20 Warranty.....</b>	<b>8</b>

# 1 Features

- Large LCD with touch keypad
- Plug-in flash tube – longer lifetime, easily replaceable
- Flash settings from 1/32 to 1/1 in 6 steps, 1/10 energy variable
- Integrated processor for a more precise power setting
- Intelligent ventilation system (fan)
- Overheating protection and overpressure protection
- Switchable acoustic signal

## 2 About this Instruction Manual



### NOTICE

**These operating instructions are to be considered a component of the device.**

Please read the safety instructions and the operating instructions carefully before use.

Keep these instructions for renewed use at a later date. When the device is sold or given to someone else, the instruction manual must be provided to the new owner/user of the product.

## 3 Intended Use

- This device is not intended for use by individuals (including children) with limited physical, sensory or mental capabilities or those lacking in experience and/or knowledge, unless they are supervised by an individual responsible for their safety or have received instructions from them regarding the use of the device.
- This product is intended only for private use.
- The device is intended only for indoor use.

## 4 Parts overview and scope of delivery

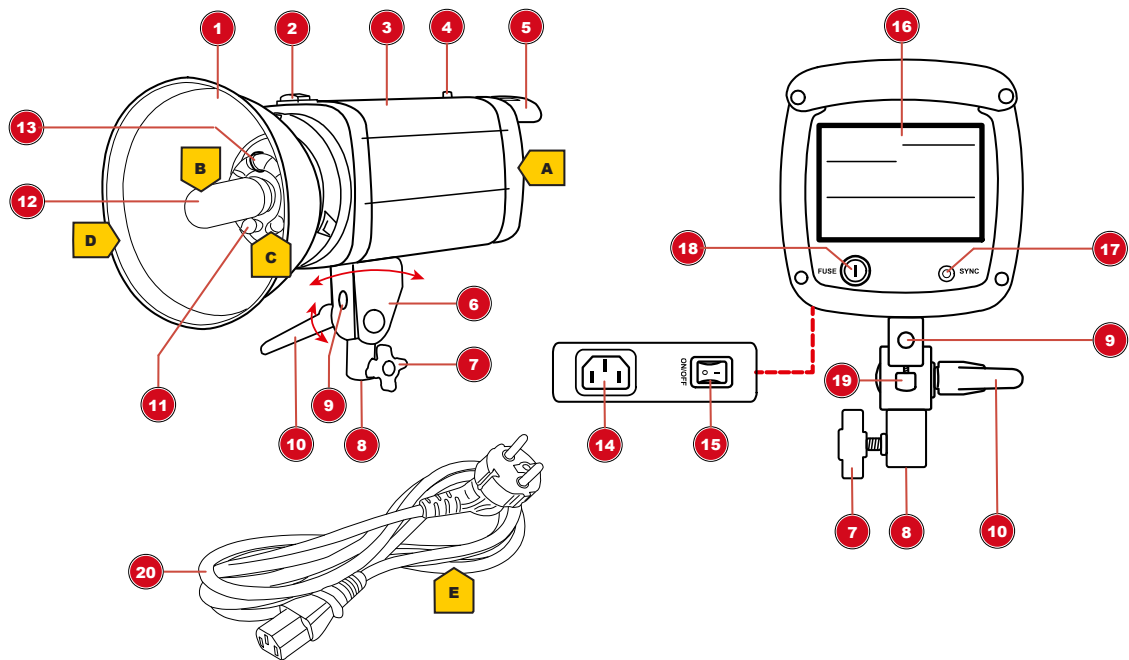

Illustration 1: Flash device parts overview

1 Reflector attachment	2 Clamping lever (Accessories mounting ring)
3 Device housing	4 Photo cell
5 Transport/Carrying handle	6 Tilt head
7 Fixing screw (tripod connection)	8 Tripod connection
9 Rod connection	10 Clamping lever (tilt head)
11 Flash tube	12 Modeling lamp
13 Fixing wire (flash tube)	14 C13 mains socket
15 ON/OFF switch	16 Display with touch control
17 SYNC connection socket	18 Fuse shaft
19 Fixing screw (rod connection)	20 C13 power cable with Euro-plug

### Scope of delivery

Flash device (A); modeling lamp (B); flash tube (C); reflector attachment (D); power cable (E); instruction manual

## 5 Screen display

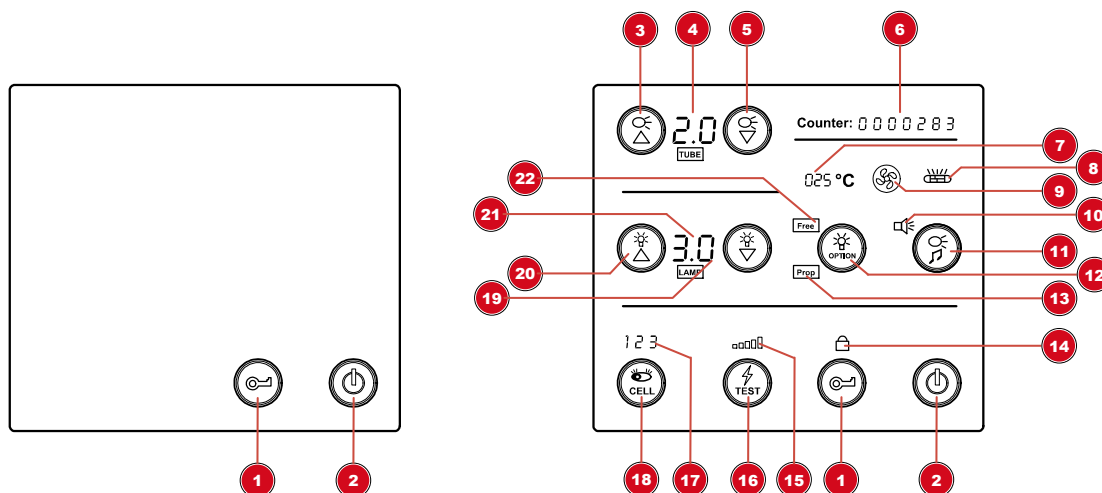

Illustration 2: Touch screen displays: start screen (left), function menu (right)

1 LOCK key	2 ON/OFF key
3 FLASH-UP key	4 Falsh power display
5 FLASH-DOWN key	6 Flash counter
7 Inside temperature display (°C)	8 Fuse symbol
9 Fan symbol	10 Acoustic signal symbol
11 SOUND key	12 OPTION key
13 Prop Symbol	14 Lock symbol
15 Flash charging indicator	16 TEST key
17 photo cell function indicator (1, 2, 3 or none)	18 CELL key
19 LIGHT-DOWN key	20 LIGHT-UP key
21 Light intensity display	22 Free symbol

## 6 Setting up power supply

1. Put the C13 coupling of the power cable into the C13 socket of the flash device.
2. Put the Euro-plug of the power cable into the wall socket (230V maximum voltage).
3. Move ON/OFF switch to position 'I' to turn on the device.

## 7 Start function menu.

1. Once the power supply was set up, the LOCK key and the ON/OFF key appear on the display.
2. If the child safety lock had been activated, tap LOCK key for approx 3 seconds to unlock the touch panel. (see "Child safety lock")
3. Tap ON/OFF key to start the device.
4. The menu and the function keys appear on the display.
5. The device now ready for use.

## 8 Select modeling light mode

1. Tap OPTION key several times to set one of the following functions. The selected function (**Free**- or **Prop**) will be displayed next to the OPTION key.

- **Free** Modeling light power can be set independently of the flash power.
  - **Prop** Modeling light power can be set only in dependence to the flash power.
2. Tap OPTION key several times until no function is displayed next to the key and the modeling light is turned off completely.

## 9 Setting the modeling light brightness

1. Tap LAMP-UP key or LAMP-DOWN key to change the value for the modeling light brightness.

**NOTICE! The setting range is between 1.0 and 6.0, whereby 1.0 is the lowest and 6.0 is the highest value.**

## 10 Setting the flash power

1. Tap FLASH-UP key or FLASH-DOWN key to change value for the flash power.

**NOTICE! The setting range is between 1.0 and 6.0, whereby 1.0 is the lowest and 6.0 is the highest value.**

2. During the flash charging process, the bar graph above the TEST key is flashing. When the bar graph stops flashing, the flash is ready for use.

## 11 Flash test triggering

1. Tap TEST key to trigger the flash once.
2. During the flash charging process, the bar graph above the TEST key is flashing.
3. When the bar graph stops flashing, the flash is ready for use.

**NOTICE! The flash counter will be increased by factor 1 with each flash triggering.**

## 12 Flash synchronization and red-eye reduction

1. Tap CELL key several times to set one of the following functions. An appropriate number next to the CELL key will indicate the selected function (1, 2 or 3).
  - Flash synchronization (1)
  - Red-eye reduction (2)
  - Red-eye reduction with double pre-flash (3)
2. Tap CELL key several times until none of the numbers is displayed next to the key. All functions are disabled.

## 13 Switching on/off the acoustic signal

Tap SOUND key several times to switch the acoustic signal on or off. Once the acoustic signal has been activated, the loudspeaker symbol appears on the display next to the key. If the acoustic signal is disabled, the loudspeaker symbol will disappear.

## 14 Cooling fan and temperature display

Inner temperature display shows the current temperature inside the housing. If the temperature rises above 25° C, the fan will be activated automatically. The fan symbol appears on the display.

## 15 Overheating protection

In normal operation mode the fuse symbol appears on the display.

If the inner temperature rises above 65° C, the overheating protection will be activated. The fuse will burst and the fuse symbol is flashing. Take the following actions:

1. Disconnect the device from the power supply and let it cool down (45 min. minimum).
2. Replace the fuse (see "Fuse replacement").

**NOTICE! If an overheating of the device occurs more often, the device might be defective. In this case, it is necessary to contact the customer service.**

## 16 Child safety lock

1. Tap LOCK key for approx. 3 seconds to activate the child safety lock. The Lock symbol appears on the display. The device cannot be operated.
2. Tap LOCK key again for approx. 3 seconds to disable child safety lock. The Lock symbol will disappear from the display. The device can be operated.

## 17 Fuse replacement

1. Disconnect the device from the power supply and let it cool down (45 min. minimum).
2. Open the fuse compartment with a suitable slot screwdriver counterclockwise.
3. Pull the fuse holder out of the shaft.
4. Remove the defective fuse.
5. Insert the new fuse into the holder.

**NOTICE! Use clean cotton gloves or a clean cloth when replacing the fuse.**

6. Push the fuse holder back into the shaft.
7. Close the fuse compartment with a slot screwdriver clockwise.

## 18 Technical data

Model	CM-300	CM-400	CM-500	CM-600	CM-800	CM-1000	CM-1200
Flash power	300Ws	400Ws	500Ws	600Ws	800Ws	1000Ws	1200Ws
Guide number	56	64	73	80	88	98	108
Flash charging time	1-2 sec.	1-2 sec.	1-2 sec.	1-2 sec.	1-2 sec.	2-3 sec.	2-3 sec.
Power range	adjustable in 6 steps from 1/32 to 1/1; 1/10 energy variable						
Modeling lamp	Halogen, 150W						
Flash tube	pluggable version; replaceable by user						
Colour temperature	5,200K to 5,600K						
photo cell operation range	up to approx. 10m						
Flash duration	1/850 sec. to 1/1500 sec.						
Overheating protection	Yes						
Fan	Yes						
Operating voltage	AC 180V - 250V at 50Hz; AC 100V - 120V at 60Hz						
Fuse	T8/250V microfuse (5x20mm), 6.3A						
Operating conditions	dry, 0° C to +40° C						
Storage conditions	dry and dust-free, 0° C to +40° C						

Table 1: CM Series

**NOTICE! The technical specifications for the flash tube refer to tests with a Hyman flash tube, produced in Germany. If using other flash tubes, the real values of this information may differ. The information on charging times refer to tests with a voltage of 220V. If using other voltage values, the charging times may differ.**

## 19 EC Declaration of Conformity

 Bresser GmbH has issued a "Declaration of Conformity" in accordance with applicable guidelines and corresponding standards.

## 20 Warranty

The regular guarantee period is 2 years and begins on the day of purchase. To benefit from an extended voluntary guarantee period as stated on the gift box, registration on our website is required.

You can consult the full guarantee terms as well as information on extending the guarantee period and details of our services at [www.bresser.de/warranty\\_terms](http://www.bresser.de/warranty_terms).



**DE** Besuchen Sie unsere Website über den folgenden QR Code oder Weblink um weitere Informationen zu diesem Produkt oder die verfügbaren Übersetzungen dieser Anleitung zu finden.

**EN** Visit our website via the following QR Code or web link to find further information on this product or the available translations of these instructions.

**FR** Si vous souhaitez obtenir plus d'informations concernant ce produit ou rechercher ce mode d'emploi en d'autres langues, rendez-vous sur notre site Internet en utilisant le code QR ou le lien correspondant.

**NL** Bezoek onze internetpagina via de volgende QR-code of weblink, voor meer informatie over dit product of de beschikbare vertalingen van deze gebruiksaanwijzing.

**ES** ¿Desearía recibir unas instrucciones de uso completas sobre este producto en un idioma determinado? Entonces visite nuestra página web utilizando el siguiente enlace (código QR) para ver las versiones disponibles.

**IT** Desidera ricevere informazioni esaustive su questo prodotto in una lingua specifica? Venga a visitare il nostro sito Web al seguente link (codice QR Code) per conoscere le versioni disponibili.



[www.bresser.de/download/studio\\_flashes\\_CM](http://www.bresser.de/download/studio_flashes_CM)



**GARANTIE · WARRANTY · GARANTÍA · GARANZIA**



[www.bresser.de/warranty\\_terms](http://www.bresser.de/warranty_terms)





# Service

## DE AT CH BE

Bei Fragen zum Produkt und eventuellen Reklamationen nehmen Sie bitte zunächst mit dem Service-Center Kontakt auf, **vorzugsweise per E-Mail**.

**E-Mail:** [service.pse@bresser.de](mailto:service.pse@bresser.de)  
**Telefon\*:** +49 28 72 80 74 340

BRESSER GmbH  
Kundenservice PSE  
Gutenbergstr. 2  
46414 Rhede  
Deutschland

\*Lokale Rufnummer in Deutschland (Die Höhe der Gebühren je Telefonat ist abhängig vom Tarif Ihres Telefonanbieters); Anrufe aus dem Ausland sind mit höheren Kosten verbunden.

## GB IE

Please contact the service centre first for any questions regarding the product or claims, **preferably by e-mail**.

**e-mail:** [service@bresseruk.com](mailto:service@bresseruk.com)  
**Telephone\*:** +44 1342 837 098

BRESSER UK Ltd  
Unit 1 starborough Farm,  
Starborough Road, Nr Marsh Green,  
Edenbridge, Kent TN8 5RB  
Great Britain

\*Number charged at local rates in the UK (the amount you will be charged per phone call will depend on the tariff of your phone provider); calls from abroad will involve higher costs.

## FR BE

Si vous avez des questions concernant ce produit ou en cas de réclamations, veuillez prendre contact avec notre centre de services **(de préférence via e-mail)**.

**e-mail:** [sav@bresser.fr](mailto:sav@bresser.fr)  
**Téléphone\*:** 00 800 6343 7000

BRESSER France SARL  
Pôle d'Activités de Nicopolis  
260, rue des Romarins  
83170 Brignoles  
France

\*Prix d'un appel local depuis la France ou Belgique

## NL BE

Als u met betrekking tot het product vragen of eventuele klachten heeft kunt u contact opnemen met het service centrum **(bij voorkeur per e-mail)**.

**e-mail:** [info@folux.nl](mailto:info@folux.nl)  
**Teléfono\*:** +31 528 23 24 76

Folux B.V.  
Smirnoffstraat 8  
7903 AX Hoogeveen  
Nederlands

\*Het telefoonnummer wordt in het Nederland tegen lokaal tarief in rekening gebracht. Het bedrag dat u per gesprek in rekening gebracht zal worden, is afhankelijk van het tarief van uw telefoon provider; gesprekken vanuit het buitenland zullen hogere kosten met zich meebrengen.

## ES IT PT

Si desea formular alguna pregunta sobre el producto o alguna eventual reclamación, le rogamos que se ponga en contacto con el centro de servicio técnico **(de preferencia por e-mail)**.

**e-mail:** [servicio.iberia@bresser-iberia.es](mailto:servicio.iberia@bresser-iberia.es)  
**Teléfono\*:** +34 91 67972 69

BRESSER Iberia SLU  
c/Valdemorillo,1 Nave B  
P.I. Ventorro del cano  
28925 Alcorcón Madrid  
España

\*Número local de España (el importe de cada llamada telefónica dependen de las tarifas de los distribuidores); Las llamadas des del extranjero están ligadas a costes suplementarios.