

BRESSER Action Camera

Art.No. 96-33500

Instruction Manual



Content

Introduction	1
Product Warranty	2
Product Accessories.....	2
Features	2
Structure	3
Product Structure	3
Bracket Structure	4
Waterproof Case	5
Product Size.....	6
Install Different Bracket/accessory	7
Camera clip connection.....	7
Waterproof case connection	8
Install neck strap	9
Operation Guide	10
Connect to PC.....	11
Saving and playing files.....	11
Time stamp setting	12
Charging.....	12
Reset	13
Operation Indication	13
Product Specification	14

Introduction

Thank you for choosing the smallest HD sports DV. It has a unique design suitable for many recording situations. With 120 degrees wide angle, 20 metres water-proof case and high speed dynamic recording, it's perfect for recording exciting sports.

The quick start and user manual offer details of how to install and use the product, and also the information including technical parameters and important notice. Please keep it for future reference.

Product accessories



Cam*1



Bracket For
Bike*1



Bracket For
Headband*1



20 Meters Waterproof
Case *1



Cloth For Lens *1



Neck Strap *1



USB Cable*1



Camera Clip*1



User Manual*1



Micro SD card(Optional)



Lens cover*1

Features

- 20 metres underwater case
- 1280x720 pixel, 30 fps HD video quality
- 120° degree wide angle lens
- Snapshot function
- Multiple bracket for an easy and pleasant record
- Two indicators for clear direction
- Thumb size alloy housing
- AVI video format to view on PC or upload to video website
- 3 megapixels lens with perfect imaging even in low illumination
- Built-in li-battery last for 2 hours continual recording

Structure

A. Product structure:

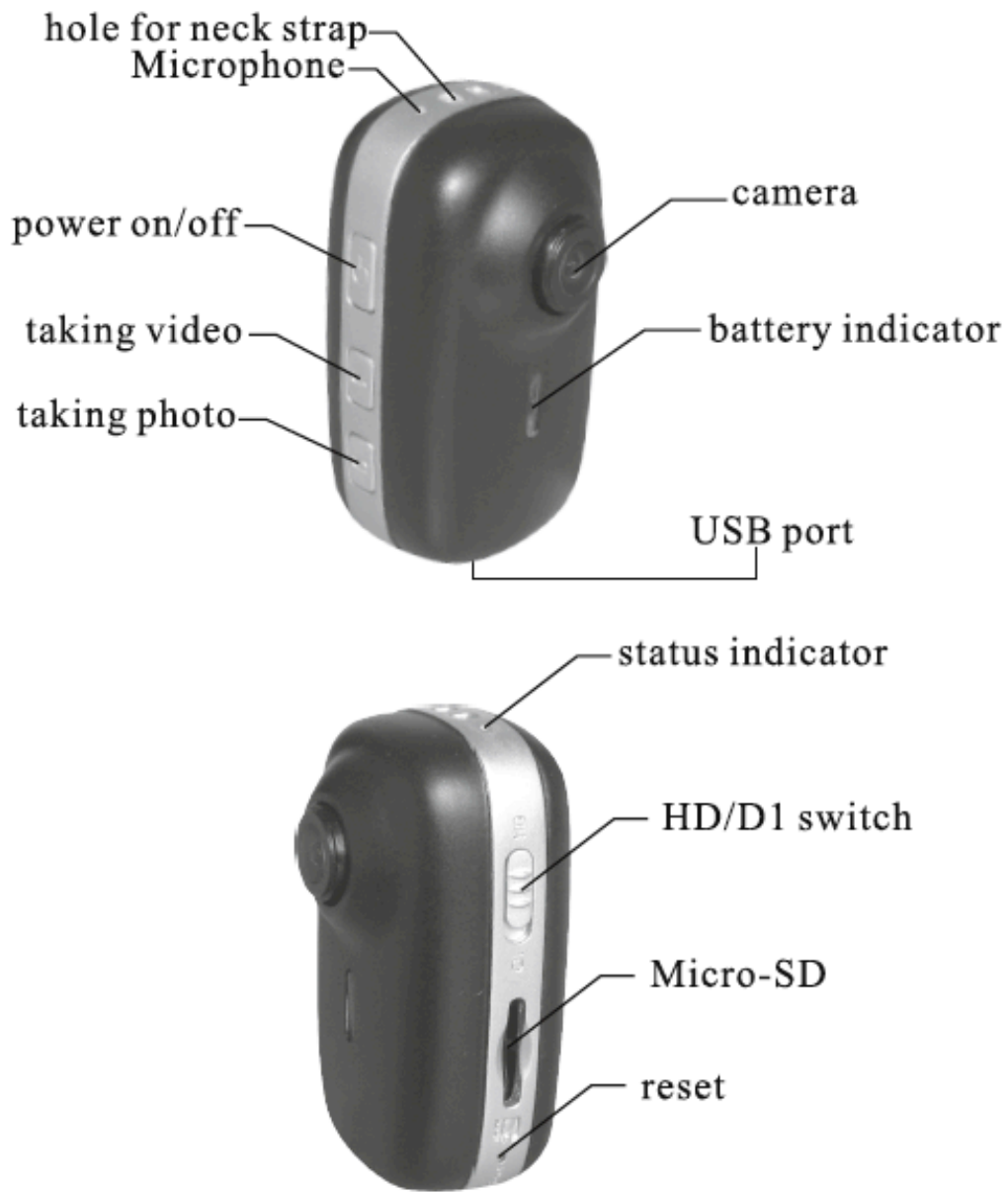

B. Bracket structure:

Bracket for headband

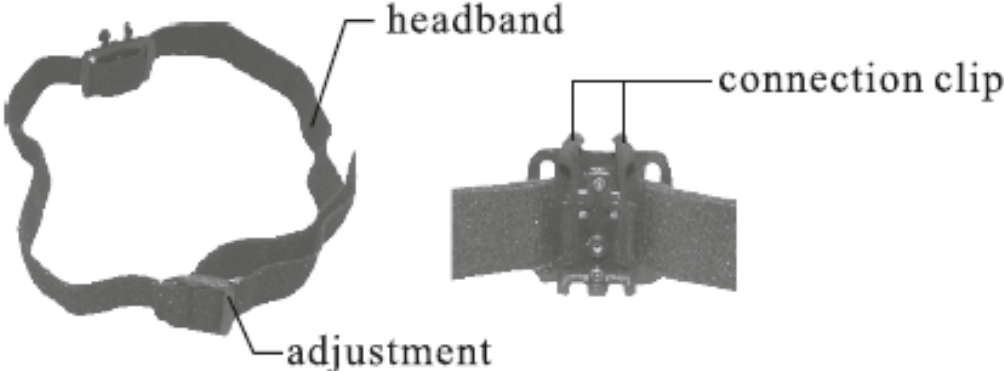

Bracket for bike

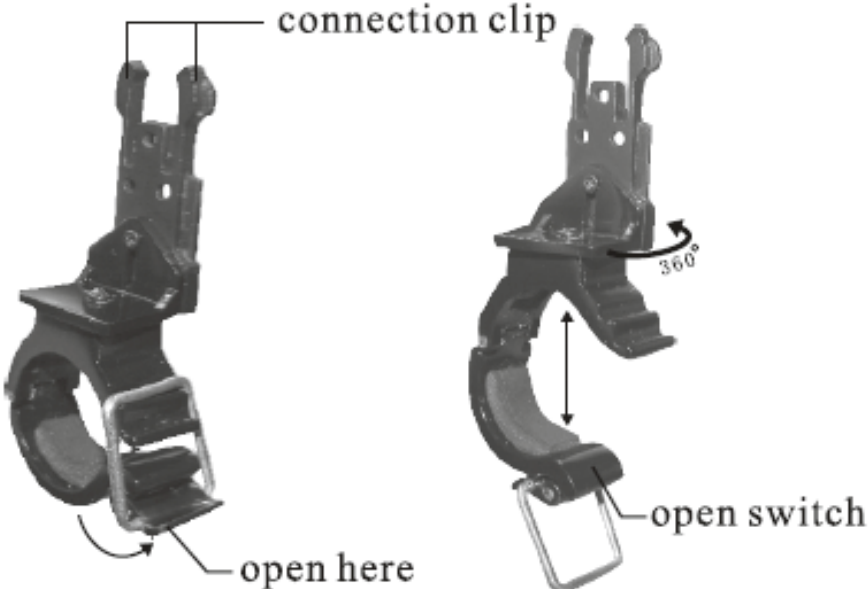

Camera clip



C. Waterproof case:

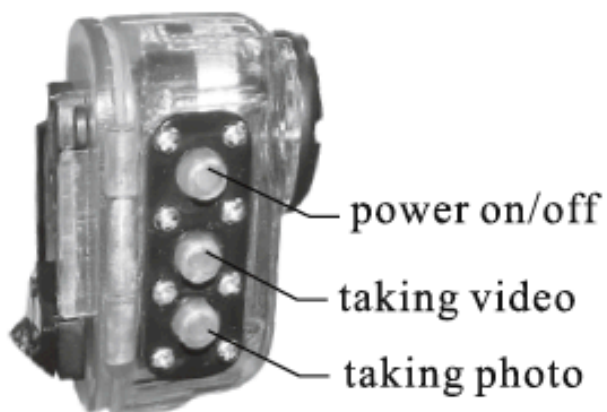
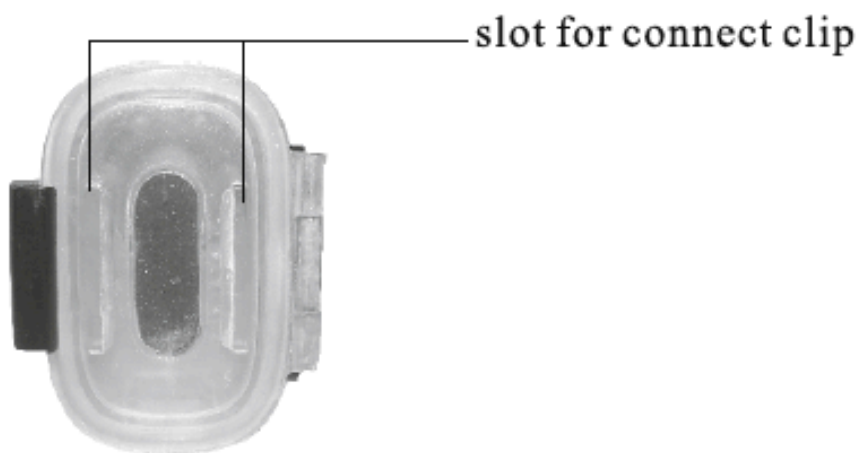
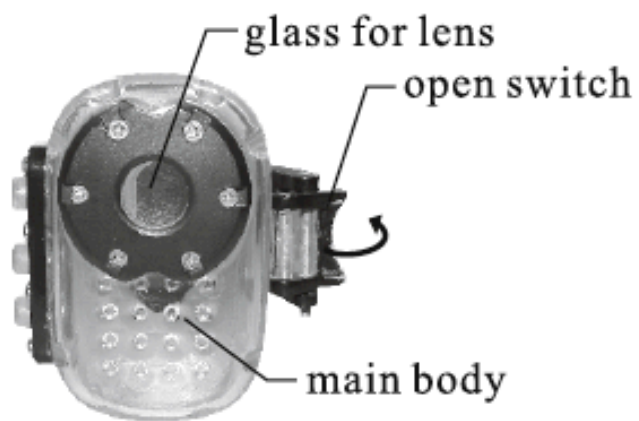

Product Size



Install Different Bracket/accessory

Camera clip connection

a) Install camera clip

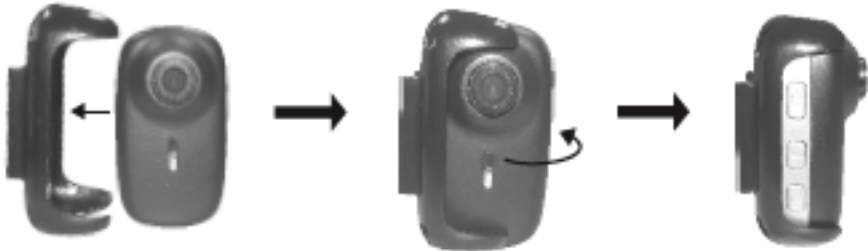

b) Headband connection



c) Bike connection

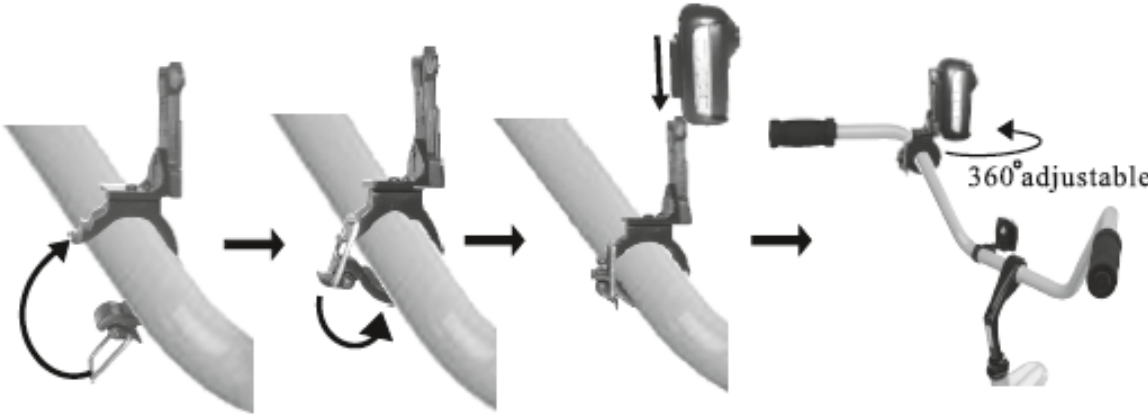

adjustment for bike close the switch camera connection adjust angle

Waterproof case connection

After using waterproof case, please clear it by fresh water as soon as possible and dry it.

Please make sure the lens cover “” is taken off before inserting the cam into the waterproof case.

a) Install waterproof case

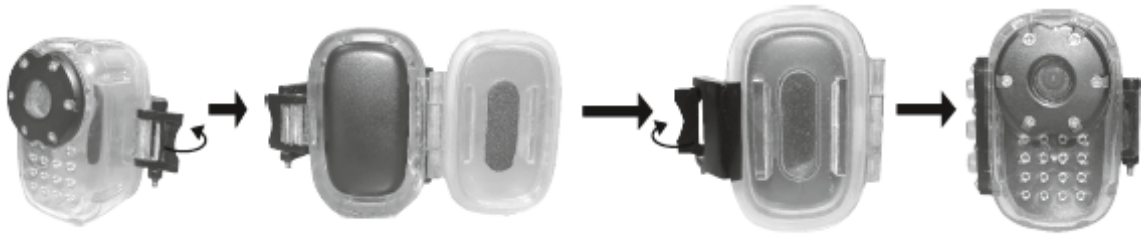

b) Headband connection



c) Bike connection

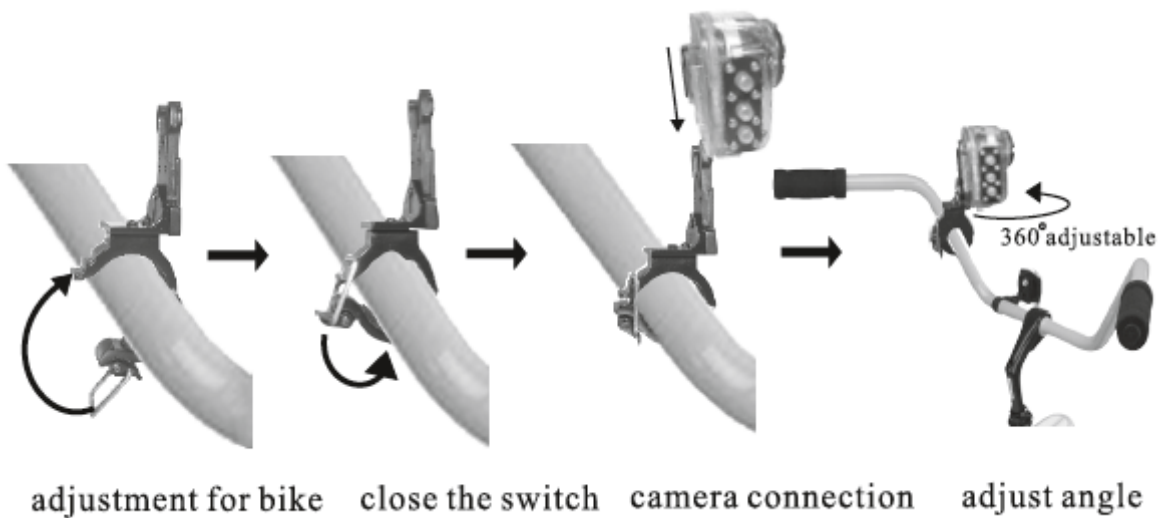

Install neck strap

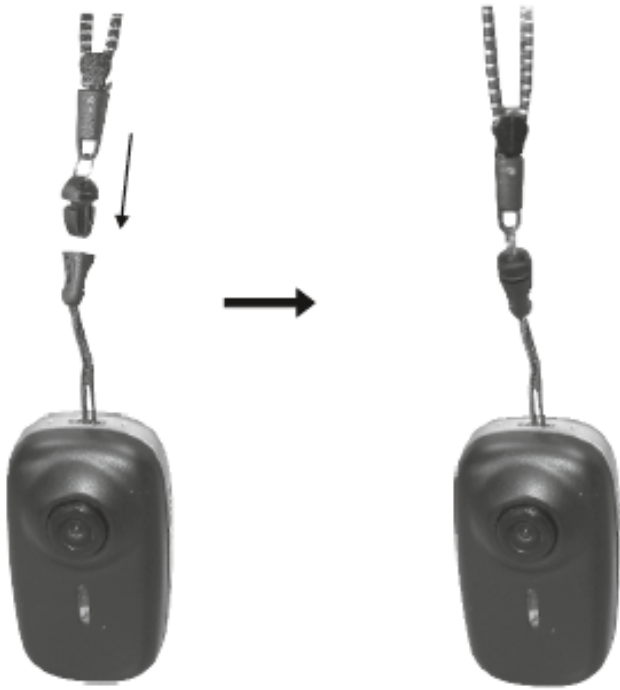
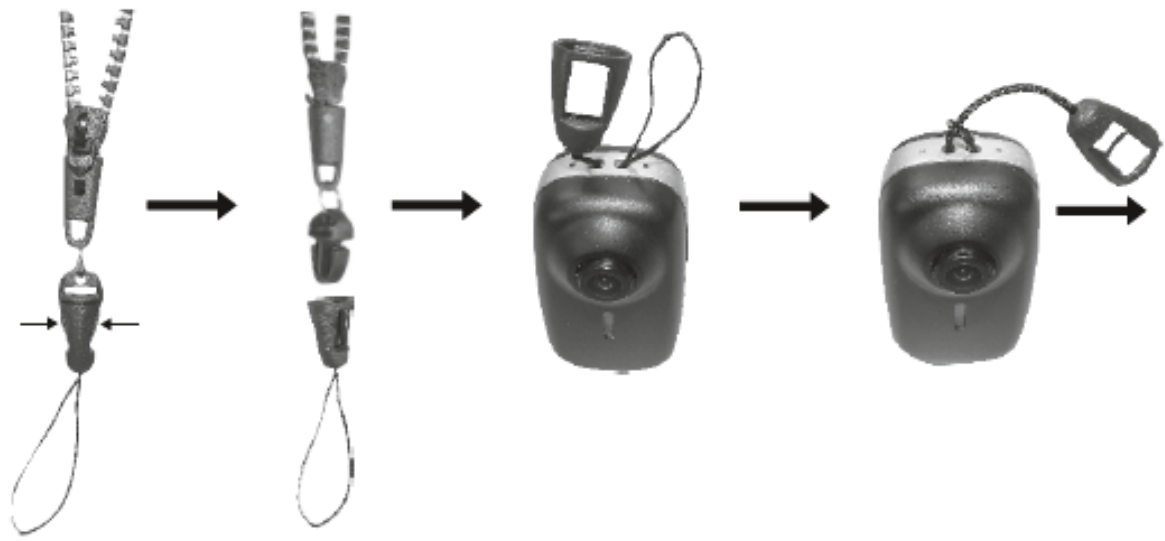

Operation Guide

1. Insert Micro SD card.



2. Press "power on". After 3 seconds the status indicator will turn on. It is not ready to go.

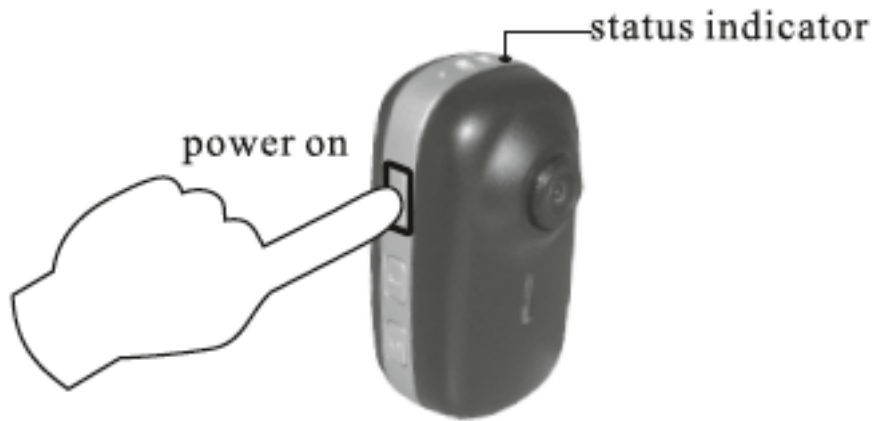

3. Before taking videos, you choose between HD resolution of 1280x720 or "D1" 848x480 pixels.



4. Press "video" to take video, the status indicator will continuously and slowly flash, one more press to stop it; or press "photo" once to take a photo, then the status indicator will flash once.

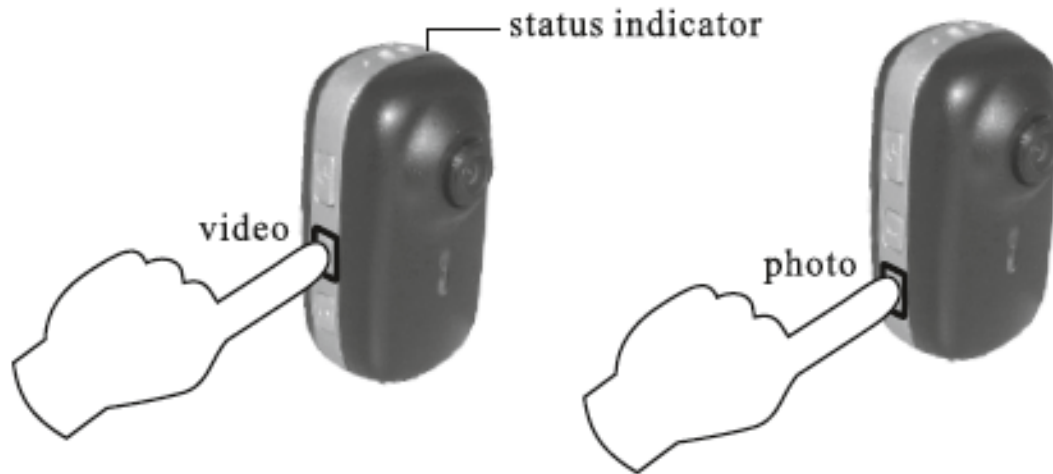

Connect to PC

A. Saving and playing files:

If you want to view the photo/video, just connect USB cable with the computer. Now it is just like a removable disk to view video/photo files.



You can also choose to remove the Micro SD card. Select a proper card reader to read the data stored in the card.

For some computer system, it may find a new device after connection. You may just cancel it, or follow the installation until it finishes.

B. Time stamp setting:

Insert micro SD card and connect the camera with PC/Notebook. Select in the window “open folder to view files”. Create a new text file under root directory and name it “TIMESET.TXT”. Then enter the current date and time (YYYY MM DD HH MM SS).

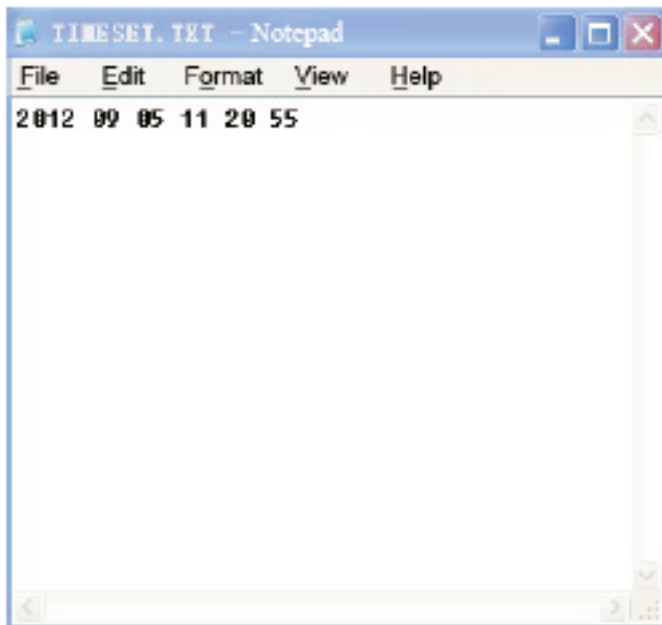

Save the file, disconnect with PC/Notebook and power it on to record. The date and time in the record state will now be shown as YYYY/MM/DD HH:MM:SS.

C. Charging:

Connect the product to your PC. The Battery indicator will flash slowly when charging. It will stay on when the battery is full.

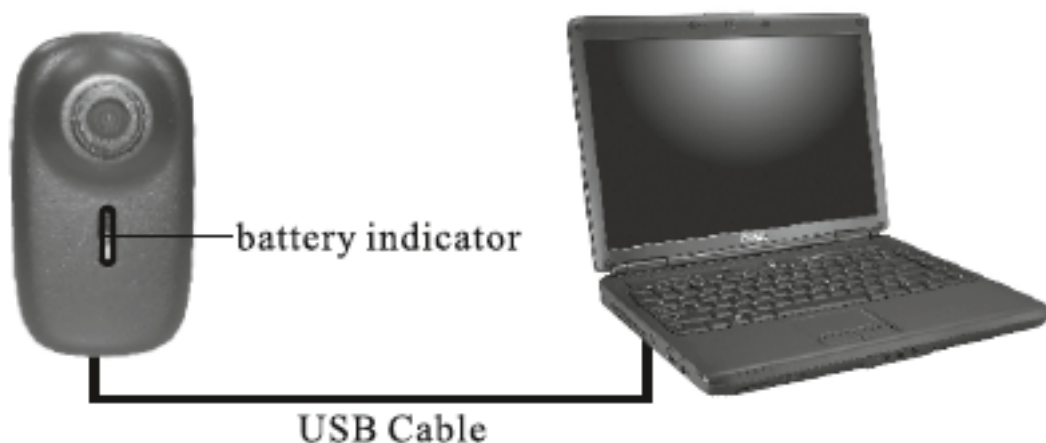

Note:

To save power, the camera will automatically power off, if there is no operation in standby situation for 15 seconds.

Reset

If the camera doesn't work, please use a tooth pick to press the “reset” button.

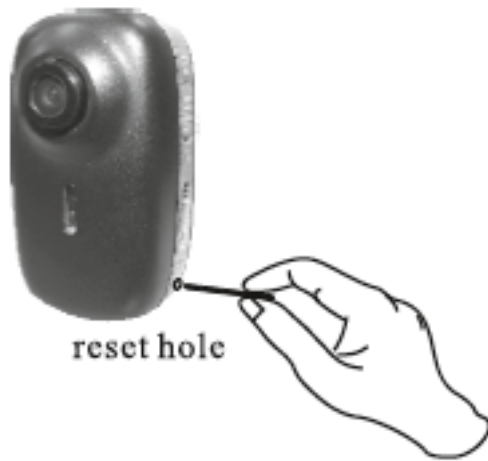

Operation Indication

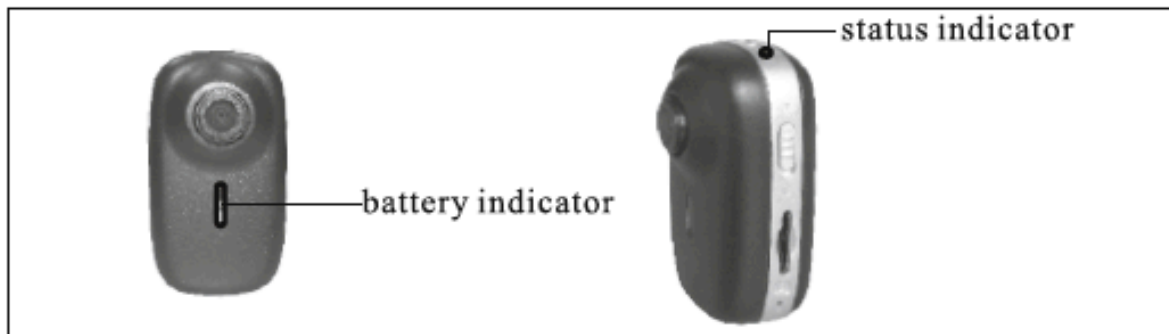

Indicator	Statue	Meaning
Battery indicator	Flash slowly	Charging
Battery indicator	Stay on	Battery is full charged
Battery indicator	Flash quickly	Low power
Battery indicator	Turn on and then off	Power on and stand by
Status indicator	On	
Battery indicator Status indicator	Both stay on	You need to reset the DV
Status indicator	Flash quickly	Micro SD is full
Status indicator	Flash once	Taking photo

Product Specification

Pixel	3,000,000 color CMOS
View angle	120 degree wide angle
Battery capacity	450 mAH
Battery recording time	About 2 hours
Consumption current	180mA/3.7V (Max)
Store temperature	-20°C -60°C
Working temperature	-10°C -50°C
Operation Humidity	15-85%RH
Memory Medium	Micro-SD (TF Card)
Memory capability	2-32GB suggested
Video format	Motion JPEG; AVI format
Size of video file	Max 120M per minute(under 1280*720)
Video pixel	1280*720 or 848*480 optional
Video FPS	25-30FPS depends on illumination
Picture pixel	2048*1536
USB jack	USB1.1/2.0
Operation system	Win98/2000/me/XP/vista/Win7/MAC
Waterproof stand	IP 68(for water-proof case)
Waterproof depth	>20 meters
Record time display	Available
Weight of camera	24g approx.
Dimension of camera	3*2.6*5.2cm approx.



Bresser GmbH
Gutenbergstr. 2
DE-46414 Rhede
www.bresser.de - info@bresser.de